

**COMPUTER FREEHOLD REGISTER
UNDER LAND TRANSFER ACT 1952**



R. W. Muir
Registrar-General
of Land

Search Copy

Identifier CB35D/1017
Land Registration District Canterbury
Date Issued 03 December 1993

Prior References

CB35D/796

Estate Fee Simple
Area 105.0400 hectares more or less
Legal Description Lot 2 Deposited Plan 64435

Proprietors

Waimate District Council

Interests

524671 Transfer creating the following easements

Type	Servient Tenement	Easement Area	Dominant Tenement	Statutory Restriction
Water pipe easement	Section 25-26 Block VII Waitaki Survey District - CT CB30B/874	Part	Lot 2 Deposited Plan 64435 - herein	

Subject to Part IV A Conservation Act 1987

Subject to Section 11 Crown Minerals Act 1991

A84839.1 Certificate pursuant to Section 321(3)(c) Local Government Act 1974 - 3.12.1993 at 11.10 am

A84839.4 Easement Certificate specifying the following easements - 3.12.1993 at 11.10 am

Type	Servient Tenement	Easement Area	Dominant Tenement	Statutory Restriction
Right of way	Lot 1 Deposited Plan 64435 - CT CB35D/1016	A	Lot 2 Deposited Plan 64435 - herein	

The easement specified in Easement Certificate A84839.4 when created will be subject to Section 243(a) Resource Management Act

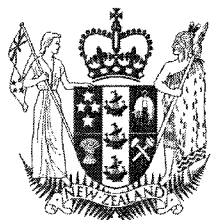

**COMPUTER FREEHOLD REGISTER
UNDER LAND TRANSFER ACT 1952**



Search Copy

R. W. Muir
Registrar-General
of Land

Identifier 43789
Land Registration District Canterbury
Date Issued 19 September 2002

Prior References
CB33A/137

Estate Fee Simple
Area 783.5752 hectares more or less
Legal Description Lot 2 Deposited Plan 311125 and Section
2A Kowhatu Settlement and Section 5
Kowhatu Settlement and Section 7
Kowhatu Settlement

Proprietors
Waimate District Council

Interests

Title Diagram CT 43789

Cpy - 01/01, Pgs - 001, 20/09/02, 13:26



DocID: 210663230

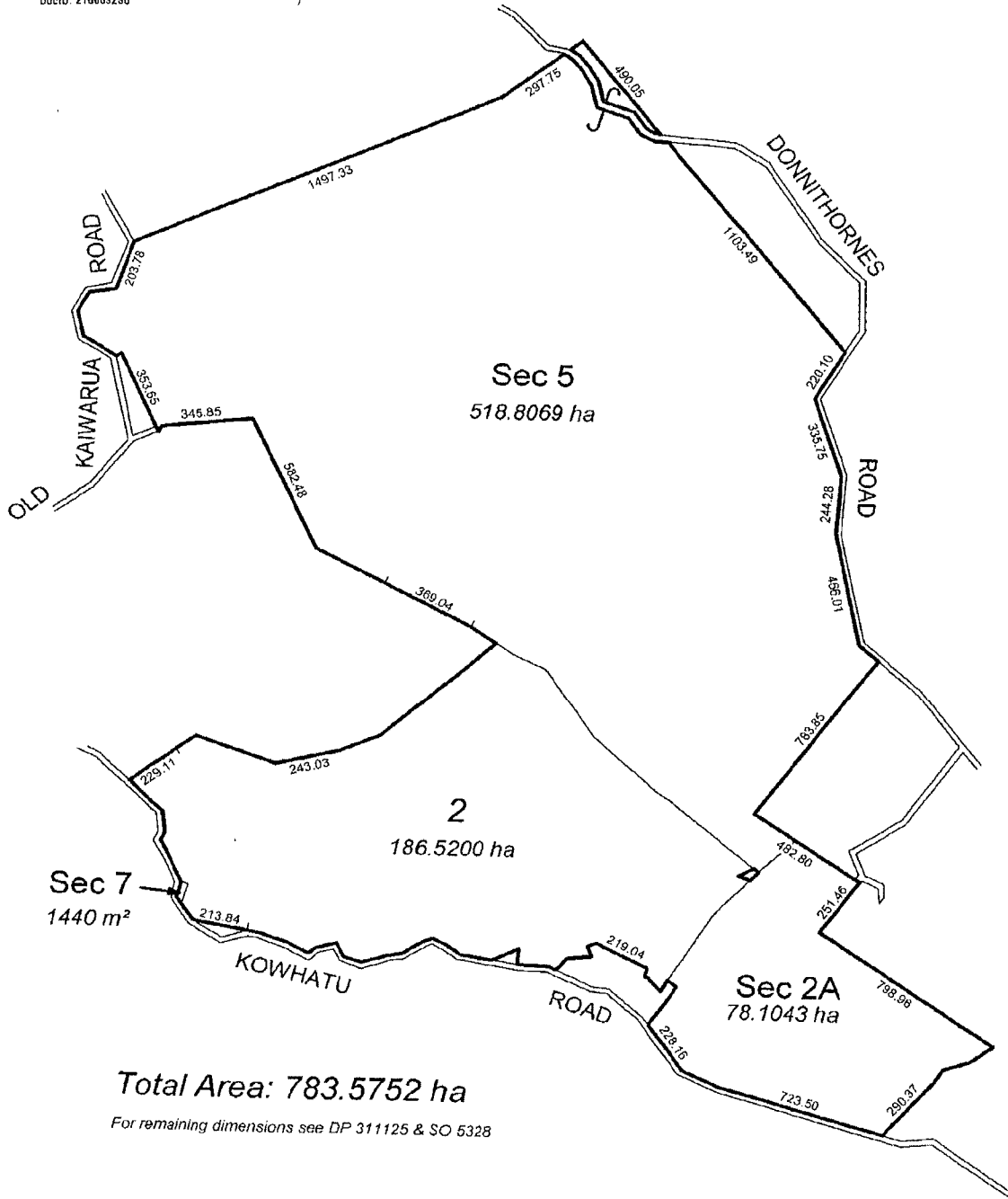

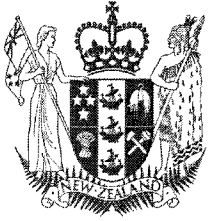

COMPUTER FREEHOLD REGISTER UNDER LAND TRANSFER ACT 1952



Search Copy

R. W. Muir
Registrar-General
of Land

Identifier CB47C/12
Land Registration District Canterbury
Date Issued 03 December 1999

Prior References

CB22A/703 CB22A/704 GN A185056.1

Estate Fee Simple
Area 325.8527 hectares more or less
Legal Description Lot 1-2 Deposited Plan 43082 and Rural
Section 42132

Proprietors

Te Runanga O Waihao Holdings Limited

Interests

Subject to Part IV A Conservation Act 1987
Subject to Section 11 Crown Minerals Act 1991
Subject to Section 59 Land Act 1948 (affects Lots 1 and 2 DP 43082)
Subject to a right of way over part Lot 1 DP 43082 herein marked A,L and over part Rural Section 42132 herein marked J, K all on DP 60170 created by Transfer 5593547.1 - 20.5.2003 at 9:00 am
5658622.4 Forestry Right pursuant to the Forestry Rights Registration Act 1983 to The Waimate District Council - 16.7.2003 at 9:00 am

